

TOOLPRO 18V Worklight

Instruction Manual

CLP18LD.9

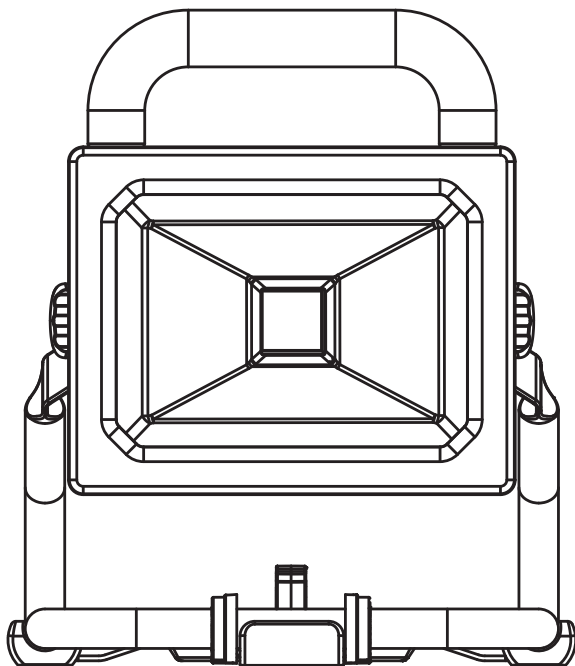

ToolPRO

After Sales Support

FREE CALL 1300 889 028
EMAIL: salesau@positecgroup.com

Important - Please read these instructions fully before operating or maintaining your Floor Light

These instructions contain important information that will help you get the best from your Floor Light, ensuring it remains safe to operate.

If you need help or have damaged or missing parts, call the Customer Helpline on 1300 889 028

Contents

Safety Information.....	3
In The Box.....	6
Operating Instructions.....	7
Maintenance and servicing.....	11
Troubleshooting.....	11
Technical Data.....	11

Safety Information

Important - Please read these instructions fully before starting assembly

Warning Symbols



To reduce the risk of injury, Please read the instruction manual



Warning



Indoor use only



Class III



Do not stare at the operating light source



Do not expose to rain or water



Do not burn



Waste electrical products must not be disposed of with household waste. Please recycle where facilities exist. Check with your local authorities or retailer for recycling advice.



Li-Ion



Li-Ion

Li-ion battery. This product has been marked with a symbol relating to 'separate collection' for all battery packs and battery pack. It will then be recycled or dismantled in order to reduce the impact on the environment. Battery packs can be hazardous for the environment and for human health since they contain hazardous substances.



Fuse



Positive terminal



Negative terminal



Read the operator's manual



Double insulation



RCM marking

ABN: Australian Business Number. By this number, business information such as entity type, status, business location etc. can be found at website <http://abr.business.gov.au>.
ABN of Positec Australia Pty Limited is 14 101 682 357

Safety Information

Important - Please read these instructions fully before starting assembly

Cordless flashlight safety warnings



WARNING! Be sure to read and understand all instructions in this manual before using this flashlight. Failure to follow all instructions may result in electric shock, fire and/or serious personal injury.

1. Please read and observe all safety warnings and instructions enclosed with the battery or the power tool, with which the battery was provided.
2. Handle the cordless flashlight with care. The cordless flashlight generates intense heat, which leads to increased danger of fire and explosion.
3. Do not work with the cordless flashlight in hazardous areas.
4. Do not direct the light beam at persons or animals and do not stare into the light beam yourself.
5. Do not cover off the lamp head while operating the cordless flashlight. The lamp head heats up during operation and can cause burns when the heat accumulates.
6. Do not stare into the light beam for longer periods. The optical radiation can be harmful for your eyes.
7. Use the cordless flashlight only with specifically designated battery pack. Use of any other battery packs may create a risk of injury and fire.

Safety Warnings for battery pack

- a) Do not dismantle, open or shred cells or battery pack.
- b) Do not short-circuit a battery pack. Do not store battery packs haphazardly in a box or drawer where they may short-circuit each other or be short-circuited by conductive materials. When battery pack is not in use, keep it away from other metal objects, like paper clips, coins, keys, nails, screws or other small metal objects, that can make a connection from one terminal to another. Shorting the battery terminals together may cause burns or a fire.
- c) Do not expose battery pack to heat or fire. Avoid storage in direct sunlight.
- d) Do not subject battery pack to mechanical shock.
- e) In the event of battery leaking, do not allow the liquid to come into contact with the skin or eyes. If contact has been made, wash the affected area with copious amounts of water and seek medical advice.
- f) Seek medical advice immediately if a cell or battery pack has been swallowed.
- g) Keep battery pack clean and dry.
- h) Wipe the battery pack terminals with a clean dry cloth if they become dirty.
- i) Battery pack needs to be charged before use. Always refer to this instruction and use the correct charging procedure.
- j) Do not maintain battery pack on charge when not in use.
- k) After extended periods of storage, it may be necessary to charge and discharge the battery pack several times to obtain maximum performance.
- l) Battery pack gives its best performance when it is operated at normal room temperature (20 °C ± 5 °C).
- m) When disposing of battery packs, keep battery packs of different electrochemical systems separate from each other.
- n) Recharge only with the charger specified by manufacturer. Do not use any charger other than that specifically provided for use with the equipment. A charger that is suitable for one type of battery pack may create a risk of fire when used with another battery pack.
- o) Do not use any battery pack which is not designed for use with the equipment.
- p) Keep battery pack out of the reach of children.
- q) Retain the original product literature for future reference.
- r) Remove the battery from the equipment when not in use.
- s) Dispose of properly.

SAVE THESE INSTRUCTIONS

Safety Information

Important - Please read these instructions fully before starting assembly

General Safety Warnings for your Battery Charger



WARNING! Read all safety warnings and all instructions. Failure to follow the warnings and instructions may result in electric shock, fire and/or serious injury.

Save all warnings and instructions for future reference.

- This appliance is not intended for use by persons (including children) with reduced physical, sensory or mental capabilities, or lack of experience and knowledge, unless they have been given supervision or instruction concerning use of the appliance by a person responsible for their safety.

- Children should be supervised to ensure that they do not play with the appliance.

If the supply cord is damaged, it must be replaced by the manufacturer, its service agent or similarly qualified persons in order to avoid a hazard.

Additional safety instructions for your Battery Charger

1. Before charging, read the instructions.
2. For charge Li-ion battery pack only.
3. Do not charge a leaking battery.
4. Do not use chargers for works other than those for which they are designed.
5. Before charging, ensure your charger matches the local AC supply.
6. The charging device must be protected from moisture.
7. Do not use the charging device in the open.
8. Do not short out the contacts of battery or charger.
9. Respect the polarity "+/-" when charging.
10. Do not open the unit and keep out of the reach of children.
11. Ensure that the connection between the battery charger and battery is correctly positioned and is not obstructed by foreign bodies.
12. Keep battery charger's slots free of foreign objects and protect against dirt and humidity. Store in a dry and frost-free place.
13. When charging batteries, ensure that the battery charger is in a well-ventilated area and away from inflammable materials. Batteries can get hot during charging. Do not overcharge any batteries. Ensure that batteries and chargers are not left unsupervised during charging.
14. Do not recharge non-rechargeable batteries, as they can overheat and break.
15. Longer life and better performance can be obtained if the battery pack is charged when the air temperature is between 18°C and 24°C. Do not charge the battery pack in air temperatures below 4.5°C, or above 40.5°C. This is important as it can prevent serious damage to the battery pack.
16. Charge only battery pack of the same model provided by manufacturer and of models recommended by manufacturer.

In The Box

Parts

- ① Handle sleeve
- ② Handle
- ③ Adjusting knob
- ④ Hook
- ⑤ Bracket seat
- ⑥ Rubber pad
- ⑦ Bracket
- ⑧ On / off switch

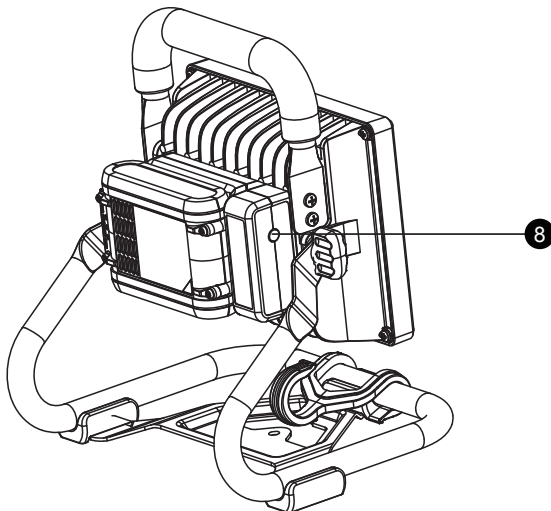
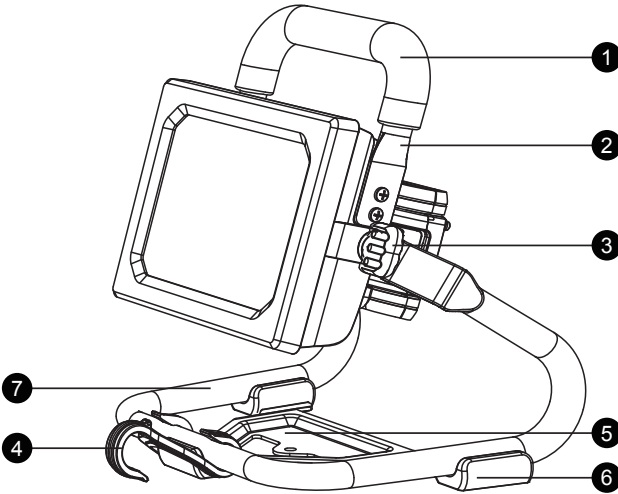

Operating Instructions



NOTE: Before using the tool, read the instruction book carefully.

Intended Use

This tool is intended for the fastening and loosening of bolts, nuts and various threaded fasteners. This tool is not intended for use as a drill.

1. CHARGING

We strongly recommend to use ToolPRO battery & charger kit. Please contact your local Supercheap Auto store for more details or log onto www.supercheapauto.com.au for Australia or www.supercheapauto.co.nz for New Zealand customers to find out more details.

BEFORE PUTTING INTO OPERATION

CHARGING THE BATTERY PACK (SEE FIG. A)

NOTE:

- a) **The battery in your new tool is not charged when it leaves the plant. Therefore it must be full charged before using the first time.**
- b) Do not use any charger other than that specifically provided for use with the equipment.
- c) If the battery pack is very hot you must remove your battery pack from the charger and allow time for the battery to cool down before recharging.
- d) Please charge the battery to reach full or no less than half charge before storage. If the tool will not be used for long periods of time, charge the battery every 3-6 months.

CHARGING PROCEDURE

- 1) Plug the charger into an appropriate outlet.
- 2) Place the battery pack into the charger
- 3) When charging is completed, unplug the charger and remove the battery pack.

Note: If the battery pack is locked in the charger, press the battery pack release button and remove it.







WARNING: When battery charge runs out after continuous use or exposure to direct sunlight or heat, allow time for the tool to cool down before re-charging to achieve the full charge.



Operating Instructions

CHARGING INDICATOR

1. Fast charger(See fig. A1)

Light	ON/OFF flash	Status
Red on 	————	Charging
Red flash 	- - - - -	Defective Battery
Green on 	————	Fully Charged
Green flash 	- - - - -	Hot/Cold Delay

2. Slow charger(See fig. A2)

Light	ON/OFF flash	Status
Green flash 	- - - - -	Charging
Green on 	————	Fully Charged

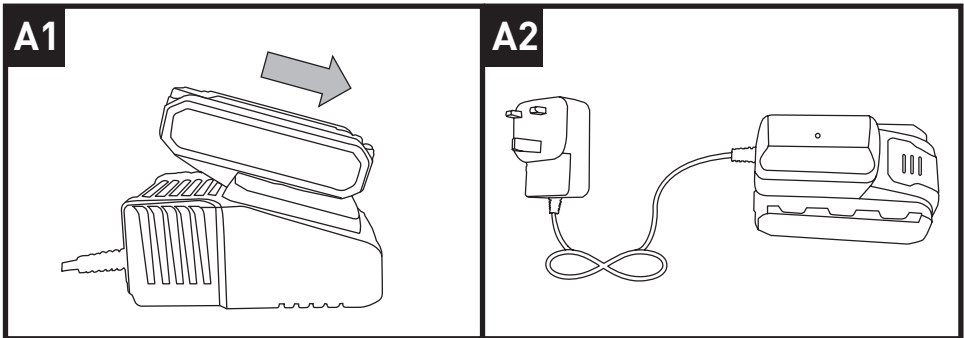

Operating Instructions

=OPERATION

1. ON / OFF SWITCH(SEE FIG D)

Press on/off switch, the Floor Light will come on.

Press on/off switch in Gear III , the Floor Light will be switched off.

2. PLACING THE LIGHT(SEE FIG E)

Place the work light securely in case of falling object hazard. Use the hook and the bracket to set the light in place. You can also use a screw to make the work light fixed on bench.



WARNING: Do not hang the work light on any electrical power cord!

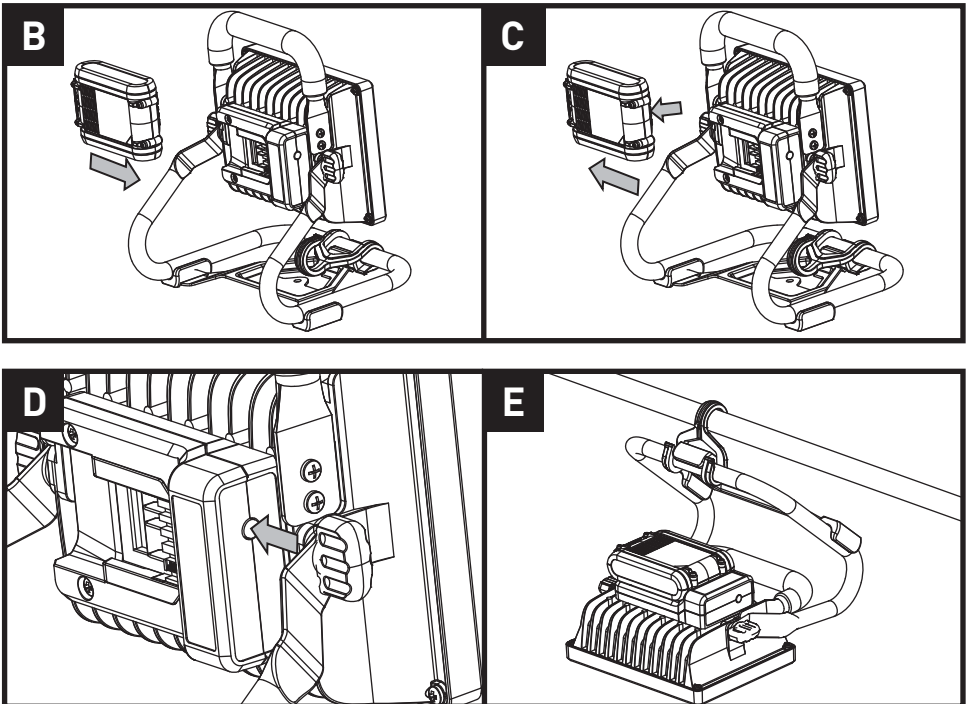

Operating Instructions

3. ADJUSTING THE HEAD OF WORK LIGHT (SEE FIG F, G)

The head of work light can be set in a variety of positions. Loose the adjusting knob to make the head of work light in place, then tighten the adjusting knob to fix the head of work light.

⚠ WARNING: Do not put hands or fingers between adjustable head and bracket when positioning the work light!

4. GEAR ADJUSTMENT (SEE FIG H)

The light has three gears.

Gear I	Press on/off switch, the Floor Light will come on.
Gear II	Press on/off switch again, the light will be brighter.
Gear III	Press on/off switch the third time, the light will be the brightest.

NOTE: If you press the on/off switch in Gear III, the light will be shut off.

⚠ WARNING: Do not direct the light beam into your eyes.

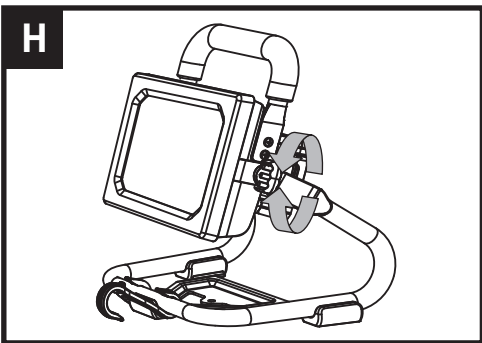
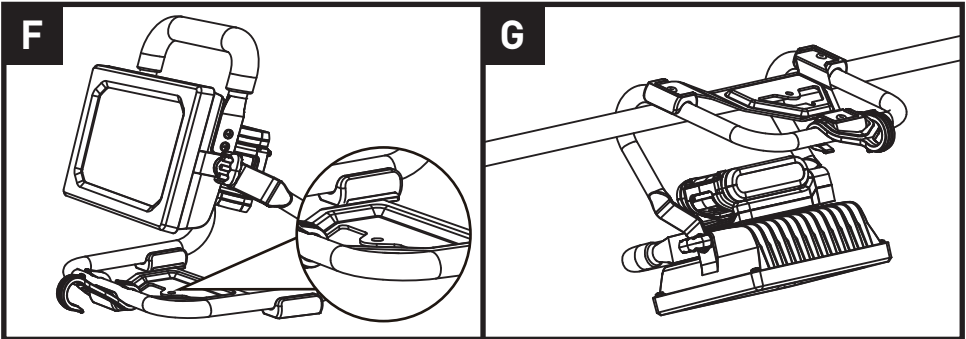

Maintenance and servicing

We recommend that you purchase your accessories listed in the above list from the same store that sold you the tool. Refer to the accessory packaging for further details. Store personnel can assist you and offer advice.

Troubleshooting

Symptom: The tool suddenly turns off during operation.

Possible Causes:



- (1) Battery temperature too high
- (2) Low battery capacity

Possible Solution:

- (1) Cool down a little while and then use again, or change the battery pack.
- (2) Charge the battery pack.

Technical Data

Technical Data Table

Rated Voltage	18V  Max 20W
Charger voltage	100-240V-50/60Hz
Working time	2hrs
lumen	1600/1000/600 LM
Machine weight	1.93kg
Charging time	1-1.5hr by fast charger, 3-5hrs by slow charger
Charger Input	100-240V-50/60Hz
Charger Output	10.8~20V  1.5A by fast charger 10.8~20V  400mA by slow charger
Battery capacity	1.5/2.0Ah Li-ion battery

Staple your purchase receipt here
Before returning this product for
warranty or any other reason, please call.
POSITEC AUSTRALIA PTY LIMITED
ABN 14 101 682 357
Unit 15, 23 Narabang Way Belrose 2085 NSW Australia
FREE CALL 1300 889 028
EMAIL:salesau@positecgroup.com

