

FIRST TIME INSTALLATION

- Please read instructions carefully before installation.
- Check the contents of kit. Contact your dealer if any parts appear to be missing or damaged.
- Clean your roof racks/platform prior to fitting the Recovery Track Holder Kit.



TOOLS REQUIRED:

- 13 mm Spanner
- 13 mm Socket and Ratchet (Baseplate to bar installation only)
- Torque Wrench
- Tape Measure
- Padlock (optional)



**RECOVERY TRACKS
SOLD SEPARATELY**

THIS PRODUCT IS OPTIMISED TO WORK WITH THE FOLLOWING RECOVERY TRACKS:

- Maxtrax MkII
- Tred 1100 mm & 800 mm

KIT CONTENTS

ITEM	COMPONENT	QTY	ITEM	COMPONENT	QTY
1	Accessory Bracket	2	10	M8 x 25 mm Button Head Cap Screw	4
2	Recovery Track Baseplate	2	11	M8 T-Nut	4
3	Fixed Strap Assembly	2	12	M8 Slot Nut	2
4	Adjuster Strap Assembly	2	13	M8 Nyloc Nut	6
5	Locking Strap	1	14	M8 Oval Washer	4
6	M8 T-Bolt	4	15	M8 Round Washer	6
7	M8 x 16 mm Button Head Cap Screw	2	16	M8 Spring Washer	4
8	M8 x 18 mm Button Head Cap Screw	2	17	Allen Key 5 mm	1
9	M8 x 20 mm Button Head Cap Screw	2			

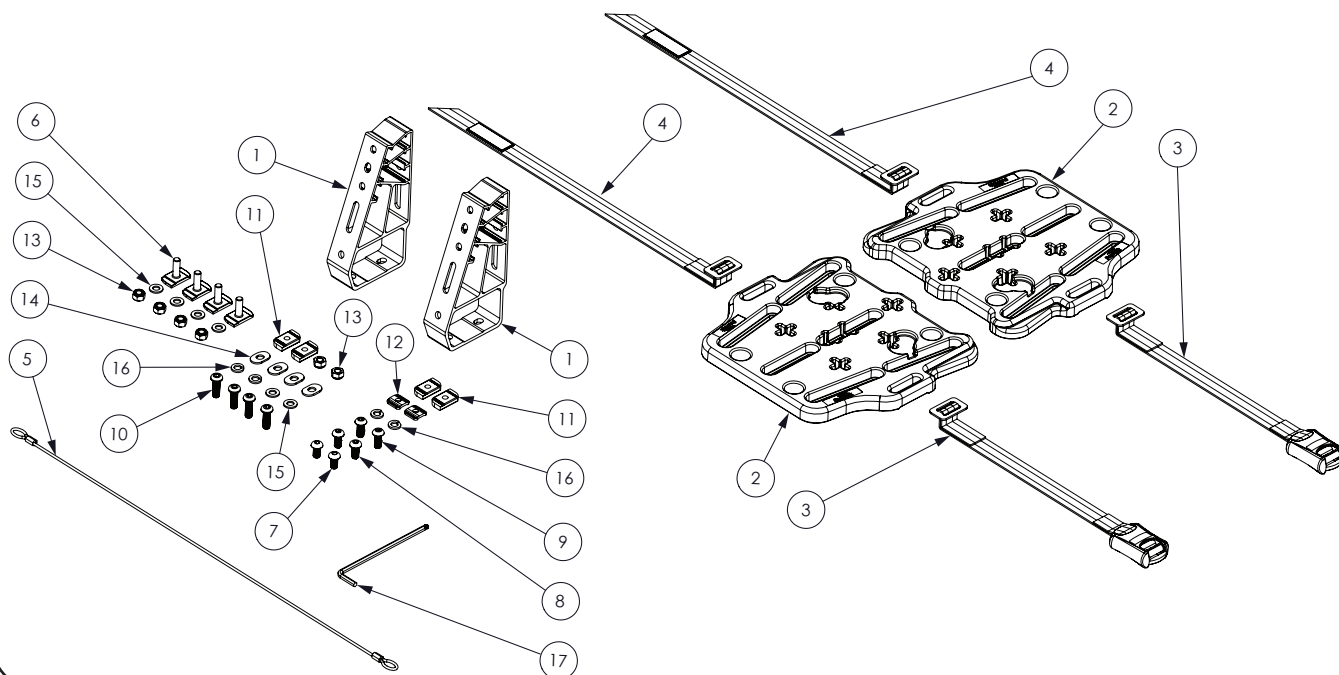

BRACKET MOUNTING CONFIGURATIONS

This product can be mounted both vertically and horizontally, face in and face out as seen below:

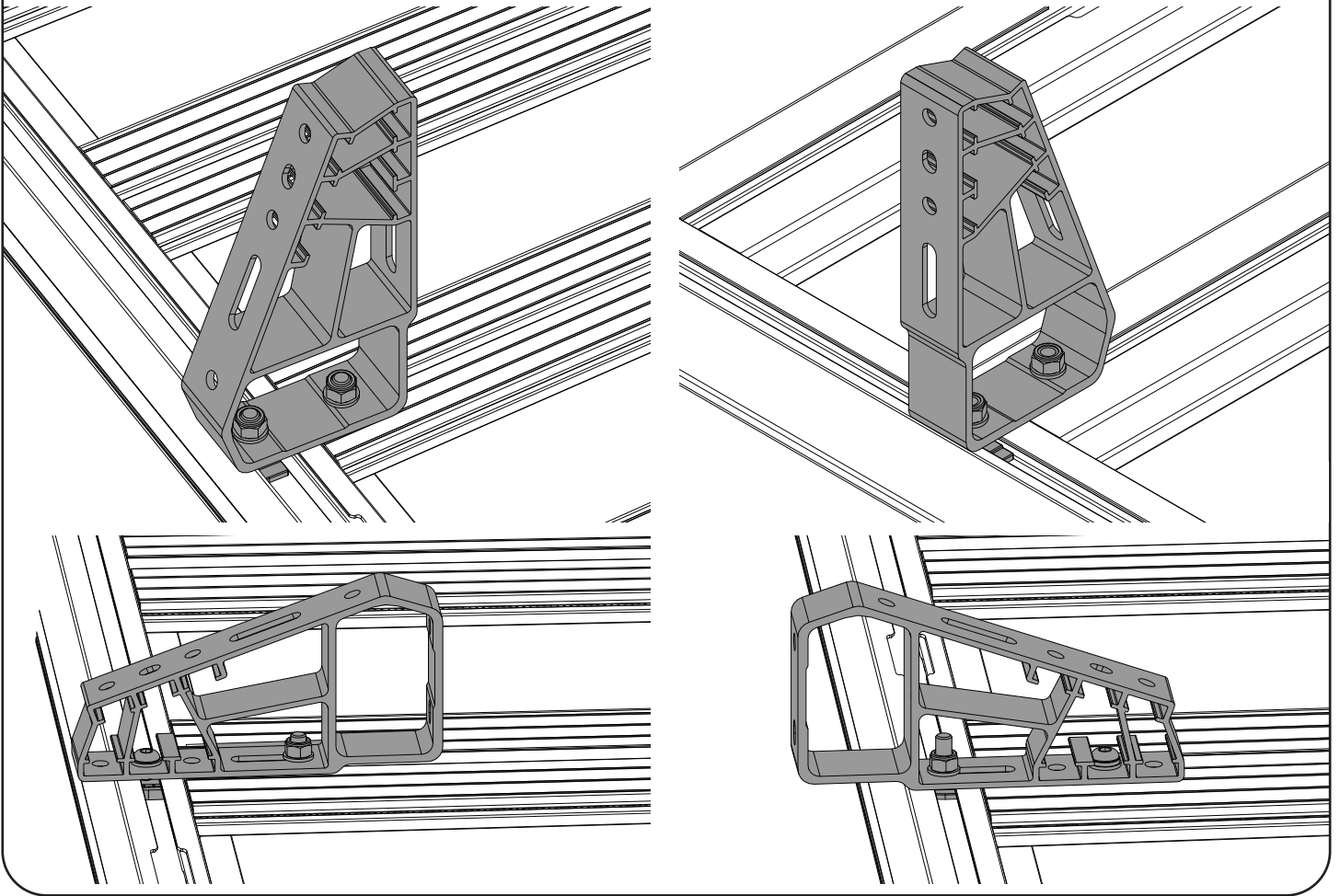

VERTICAL BRACKET INSTALLATION

1 POSITION MOUNTING T-BOLTS.

Check that the spread between the crossbars or platform slats is between 492 mm and 892 mm. Insert x2 T-bolts into the crossbars or platform as shown.

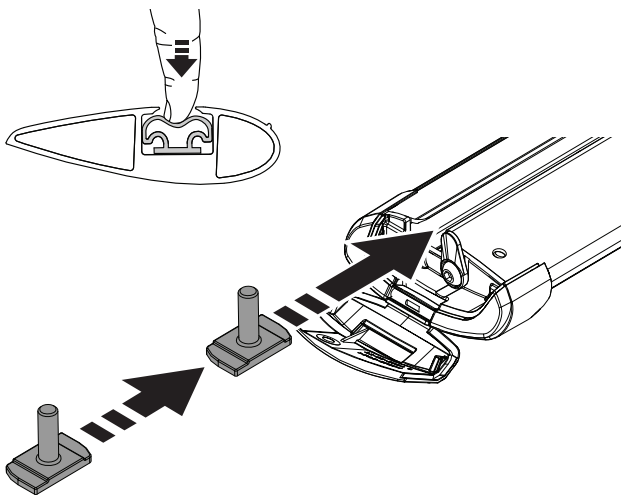

Crossbars

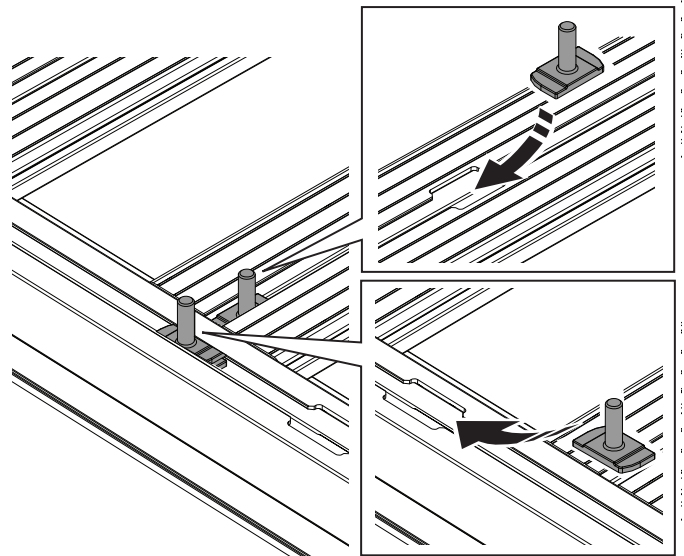

Platform

2

ATTACH BRACKET.

Position the bracket on to the T-bolts noting the two possible vertical mounting positions available. Install the M8 Nyloc nuts and M8 round washers on to the T-bolts after positioning the bracket.

Tighten the Nyloc nuts to 4 Nm using a 13 mm spanner.

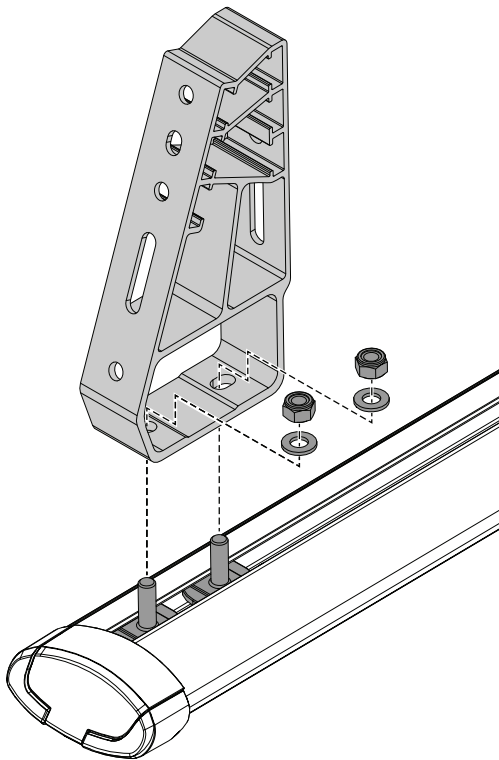

Crossbars

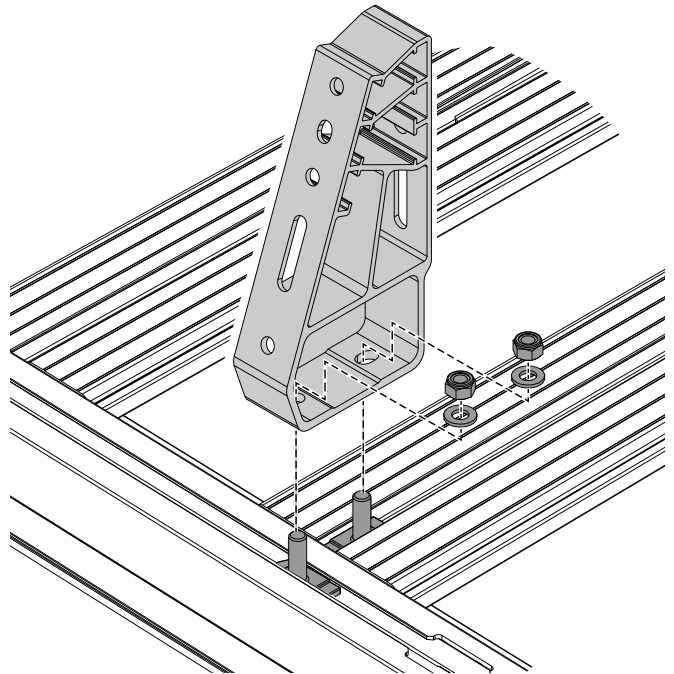

Platform

NOTE - Some bars such as HD Bars require the T-Bolt to be rotated 90 degrees before tightening as seen below.

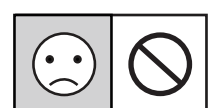
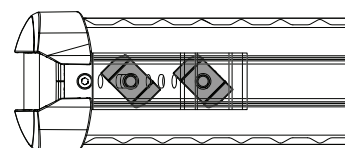
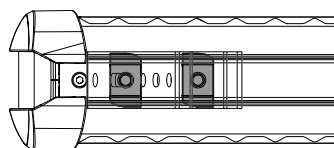
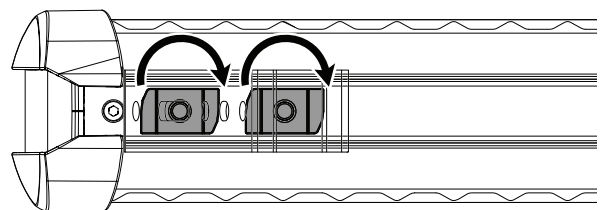
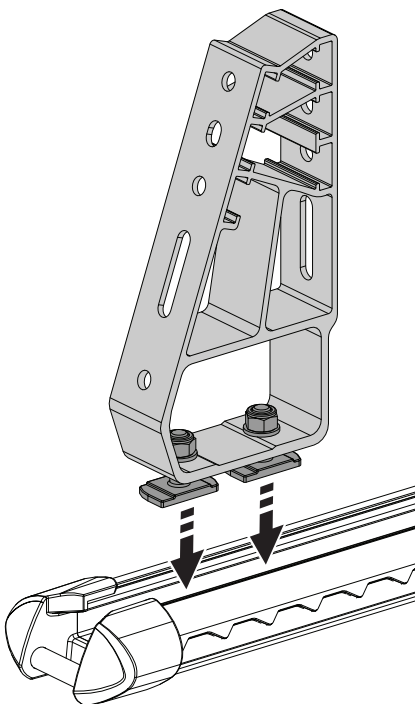

Continue to page 8 to mount the baseplates to the brackets.

HORIZONTAL BRACKET INSTALLATION

1 POSITION MOUNTING HARDWARE.

Check that the spread between the crossbars or platform slats is between 492 mm and 892 mm. The horizontal configuration requires the use of x1 T-bolt and crossbar or platform specific hardware. Insert T-bolt and nut as shown below unless highlighted otherwise in Step 2.

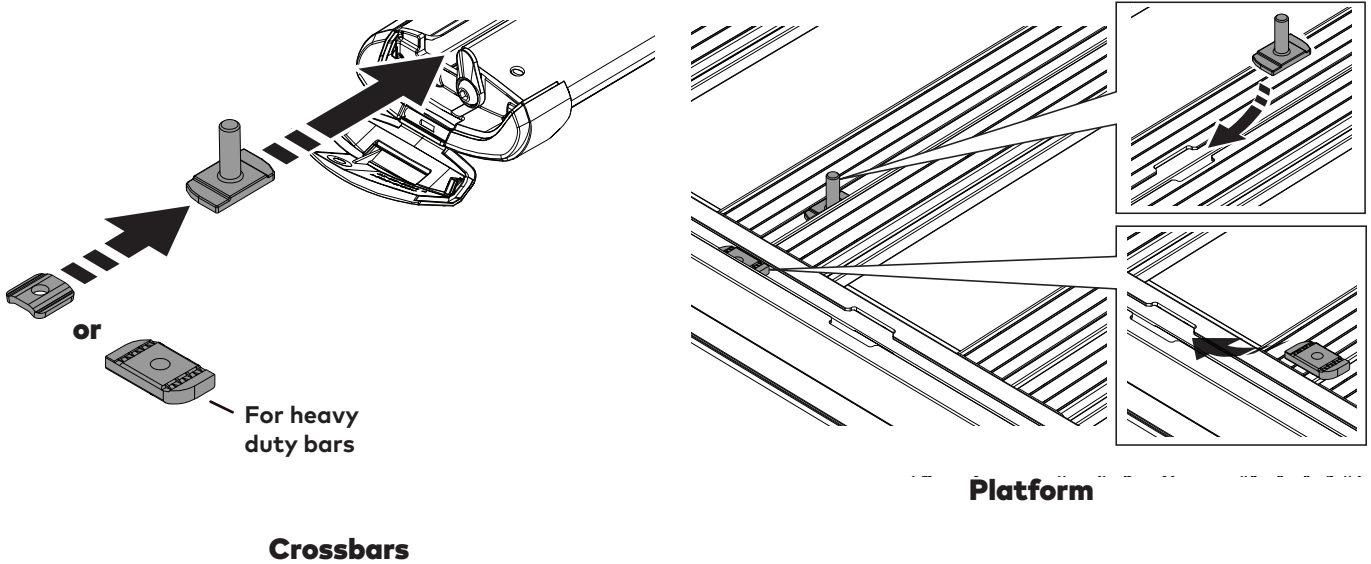

NOTE - Some bars may allow all hardware to be loosely installed and slide into place as seen below.

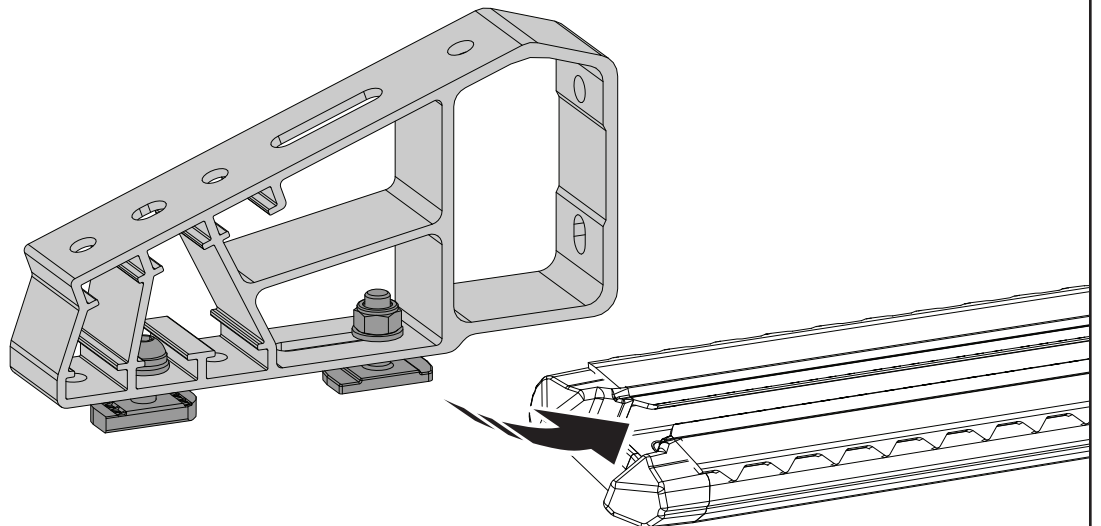

2

ATTACH BRACKET.

Crossbar and platform specific hardware:

For LockNLoad Platform:

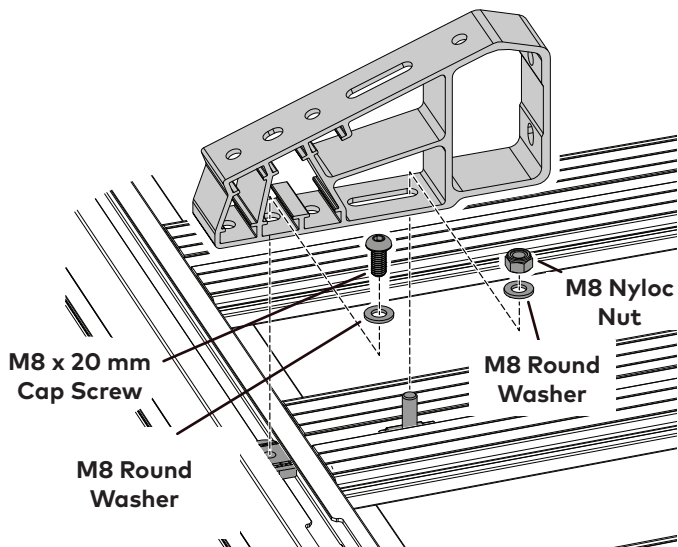

For Aero Deck:

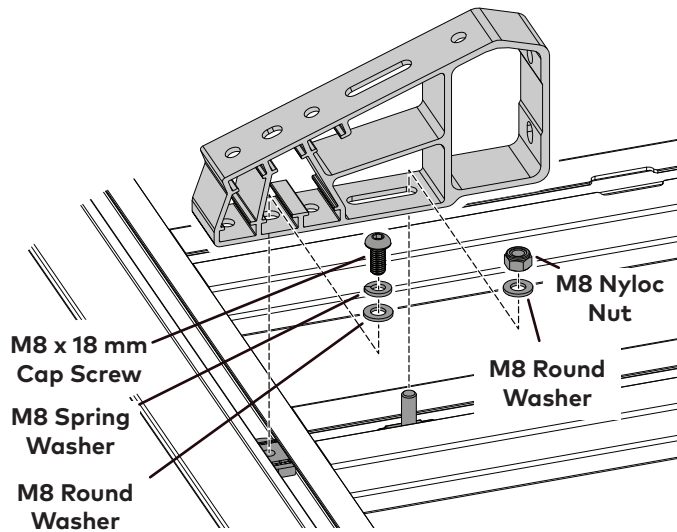

For Aero and JetSteam Bar:

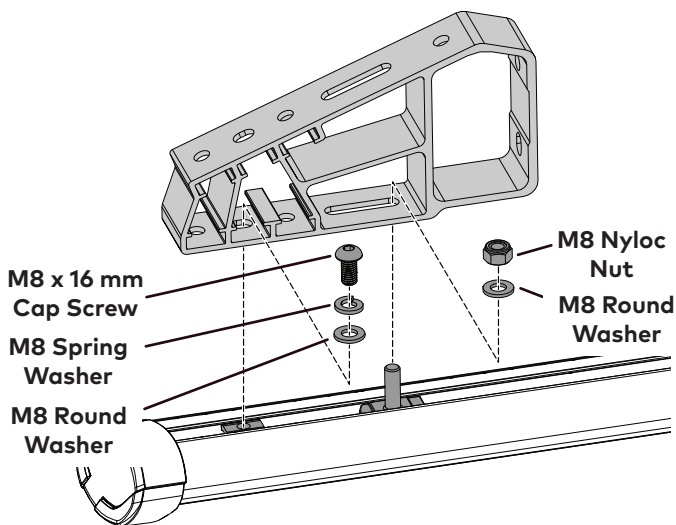

For TrimHD:

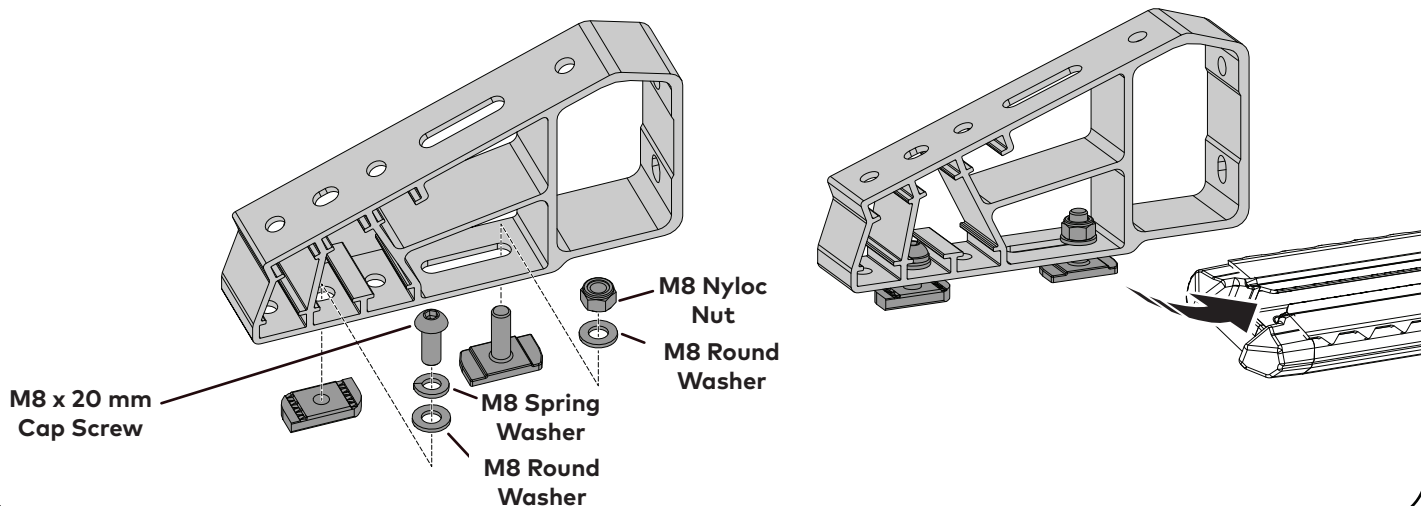

For HD Bars:

HD Bars require the T-Bolt to be rotated 90 degrees before tightening as seen below.

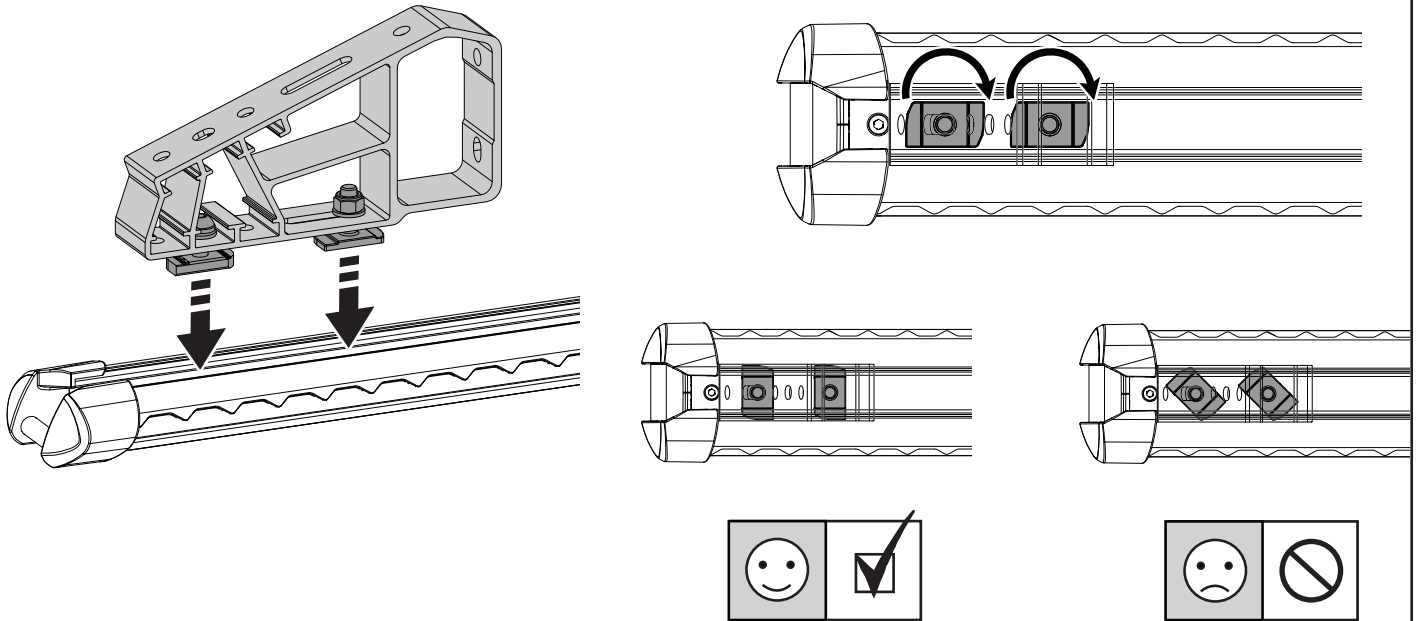

3

SECURE.

Tighten the screw to 4 Nm using the supplied 5 mm allen key through the top hole as shown. Tighten the Nyloc nut to 4 Nm using a 13 mm spanner.

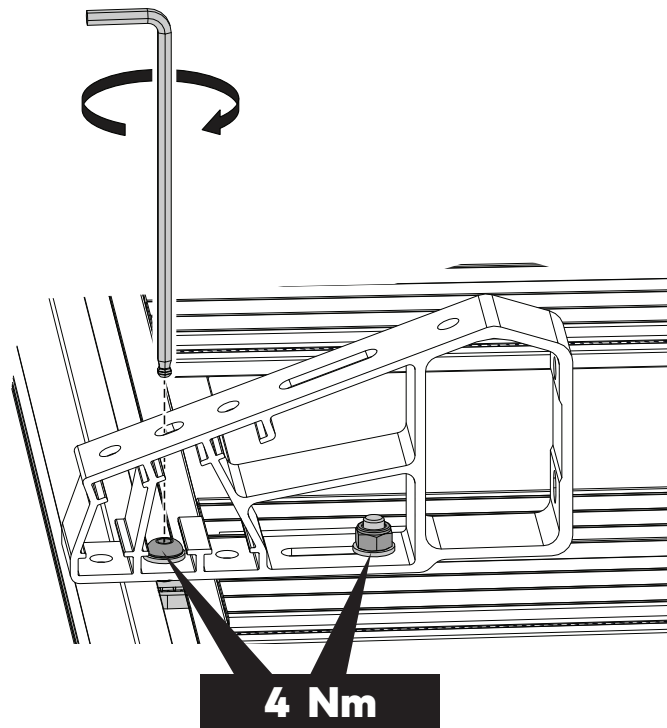

Continue to page 8 to mount the baseplates to the brackets.

BASEPLATE INSTALLATION TO BRACKET

BASEPLATE INSTALLATION TO BRACKETS

T-Nut, Washers, Spring Washer, Screws and Nyloc Nuts required.

1 BASEPLATE WIDTH.

Determine the width the plates need to be spaced.

Narrow Position

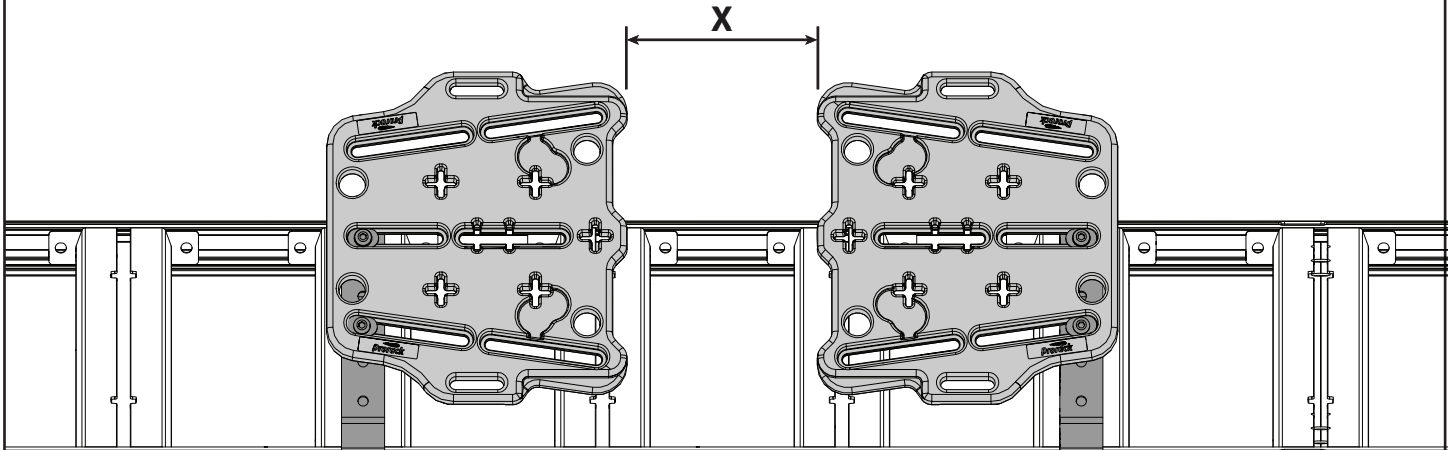

Wide Position

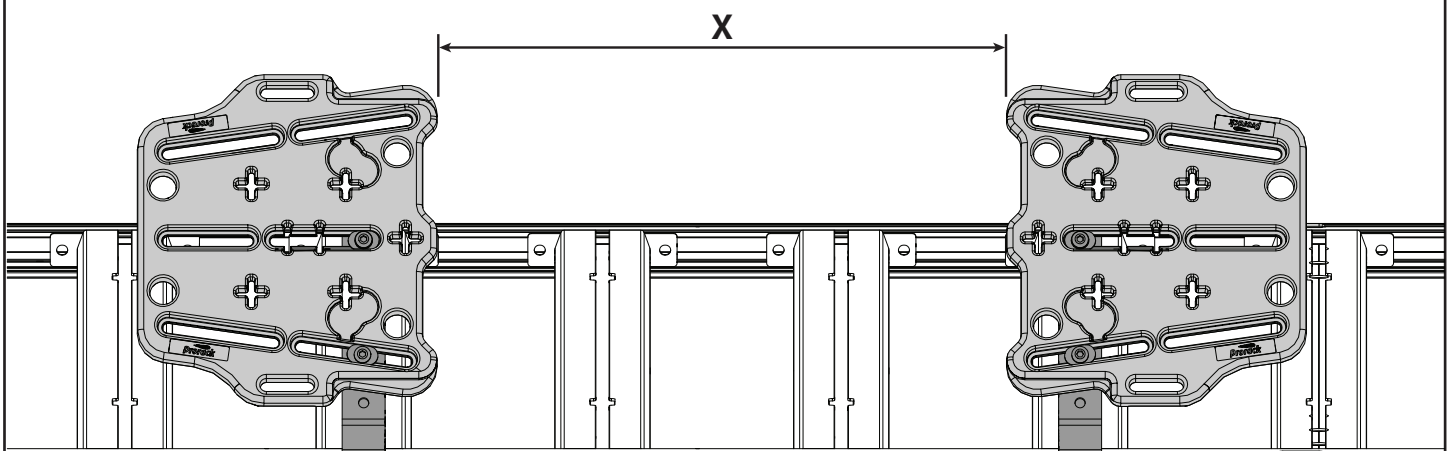

2

ASSEMBLE PARTS.

Assemble the M8 T-nuts , M8 round washers, M8 oval washers, M8 spring washers, M8 x 25 mm cap screws and Nyloc nuts onto the baseplate and accessory bracket as shown and torque to 4 Nm.

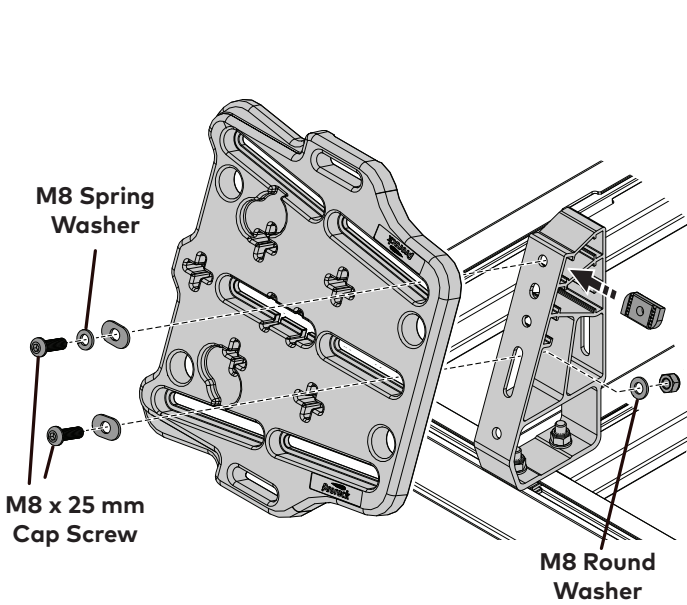

Vertical Mount Low Height Position Assembly.

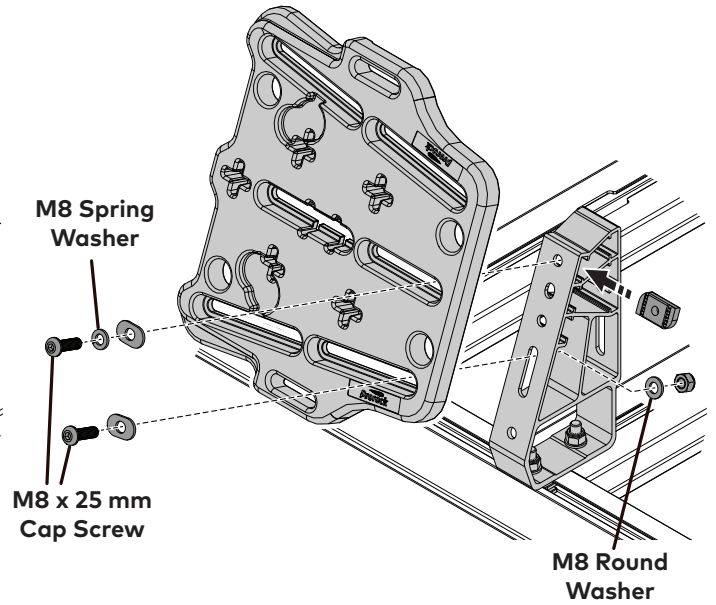

Vertical Mount High Height Position Assembly.

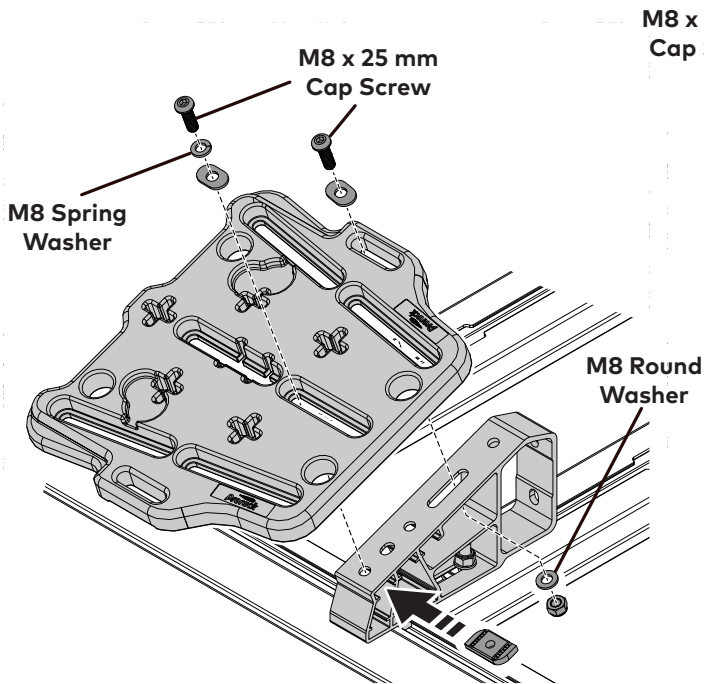

Shallow Mount Low Height Position Assembly.

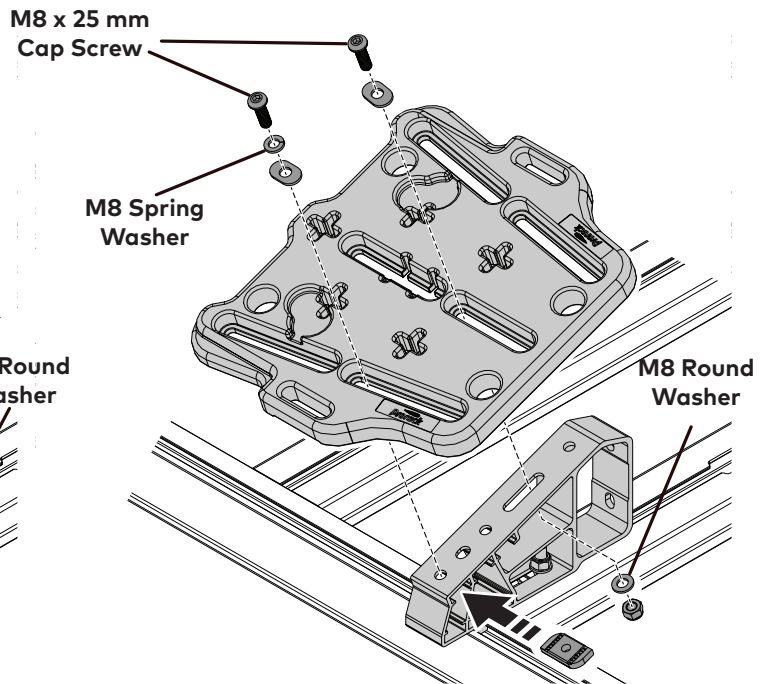

Shallow Mount High Height Position Assembly.

3 INSTALL STRAPS.

Attach straps by hooking the webbing buckles from behind and then through the outer holes on the baseplates. Ensure that the buckles are sitting flat, as pictured. Also, check that at the velcro on the adjuster strap is facing away from the vehicle, and that the velcro on the fixed strap is facing towards the vehicle.

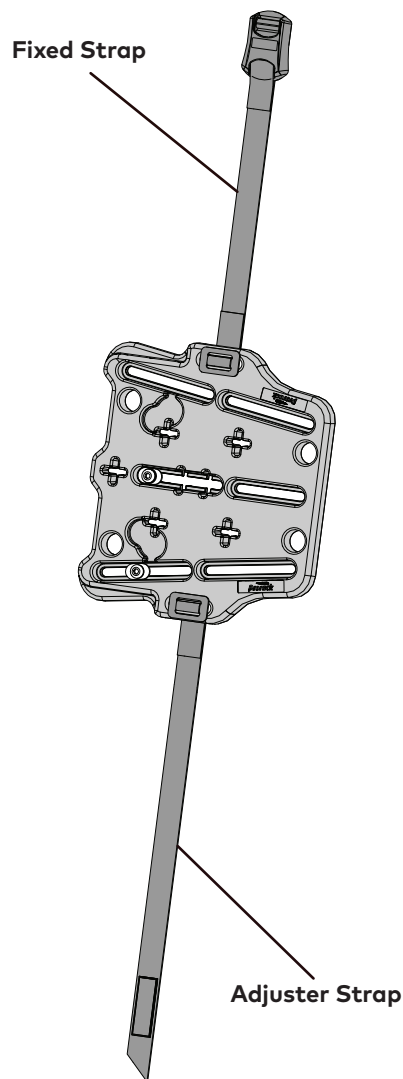
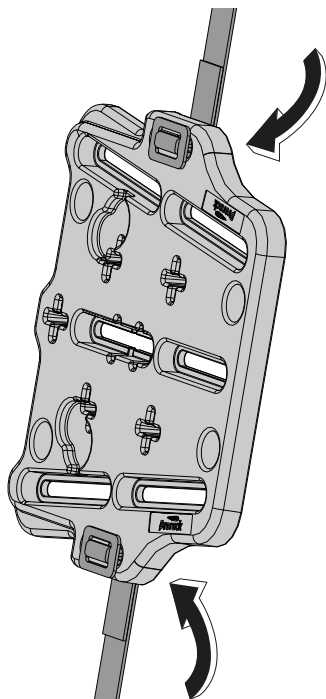

4 TIGHTEN STRAPS.

Loosely fit adjuster strap through the cam buckle in the fixed strap assembly prior to fitting recovery tracks. Insert recovery tracks through the loose straps. Locate the crosshairs on your recovery tracks into the corresponding cross slots in the baseplates. Tighten straps firmly and secure the velcro sections.

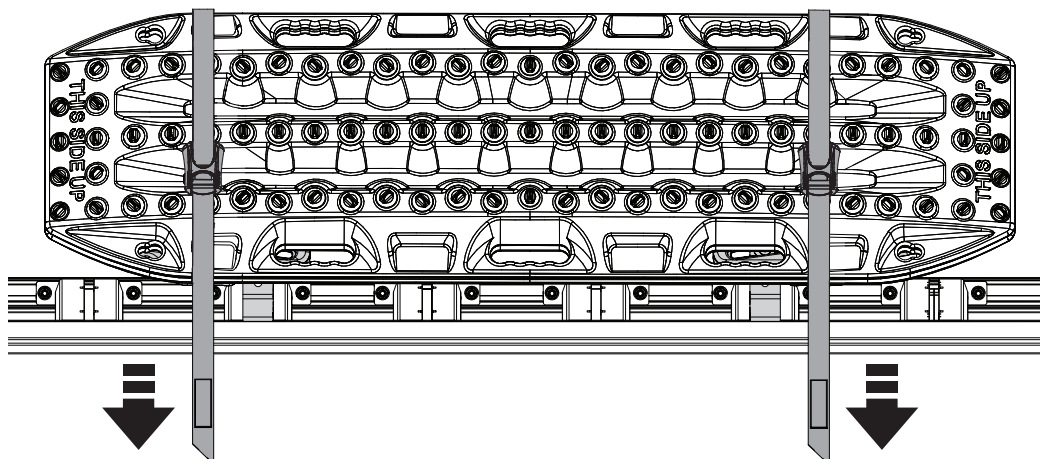
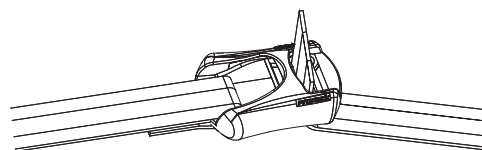

BASEPLATE INSTALLATION DIRECT TO CROSSBARS OR PLATFORM

DIRECT FLAT MOUNT TO CROSSBARS OR PLATFORM

Use T-Bolts, Washers and Nyloc Nuts supplied.

Check that the spread between the crossbars or platform slats is between 492 mm and 892 mm.

1 BACKPLATE WIDTH.

Determine the width the plates need to be spaced.

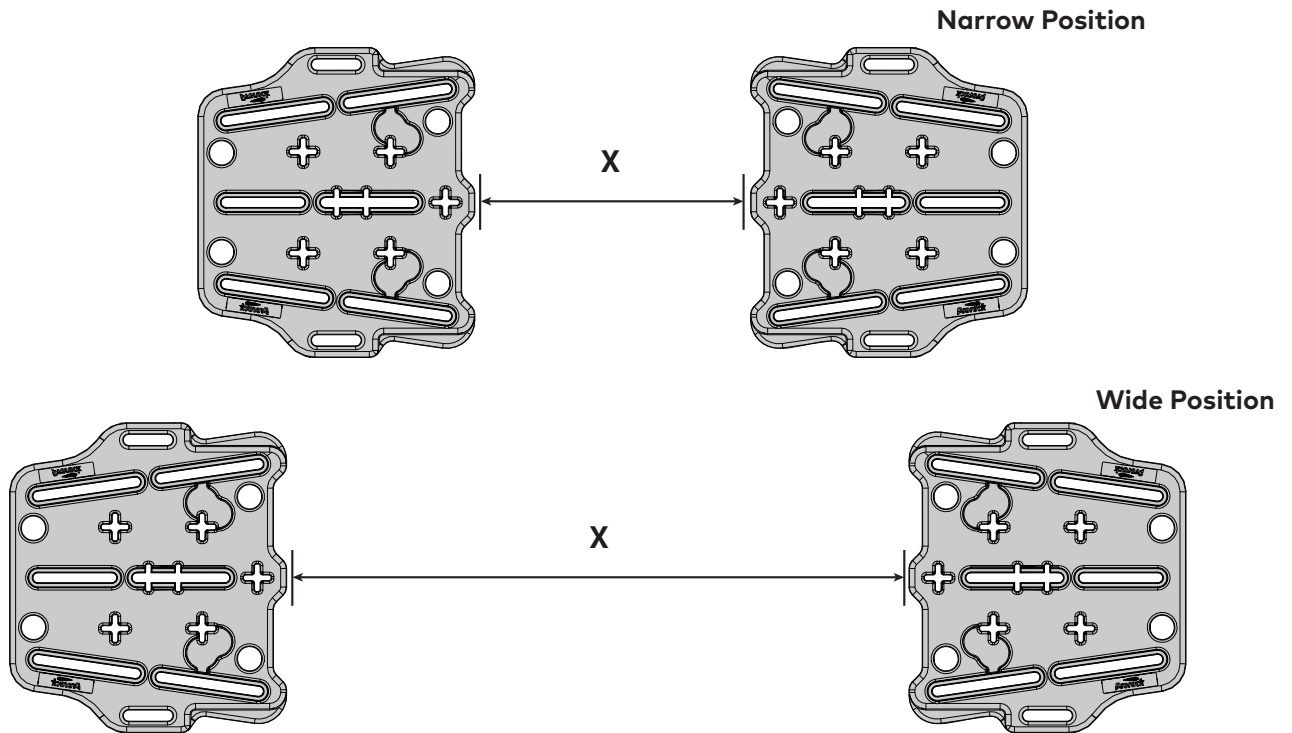

2 POSITION T-BOLTS.

Insert x2 T-bolts into the T-channel of the crossbar or platform. Depress the crossbar infill (if included) and slide the T-bolt to suit the baseplate mounting position. Repeat for the second baseplate.

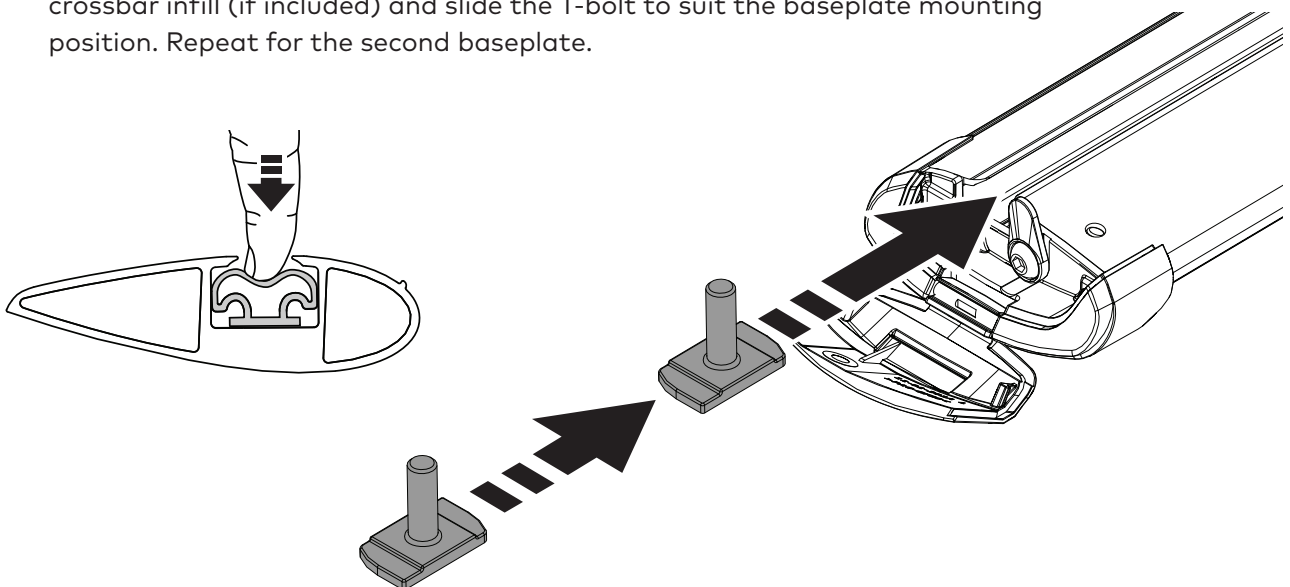

3**ASSEMBLE PARTS.**

Rest the backplate on the previously installed T-bolts. Assemble the M8 oval washers and M8 Nyloc nuts onto the backplate according to your desired mounting position.

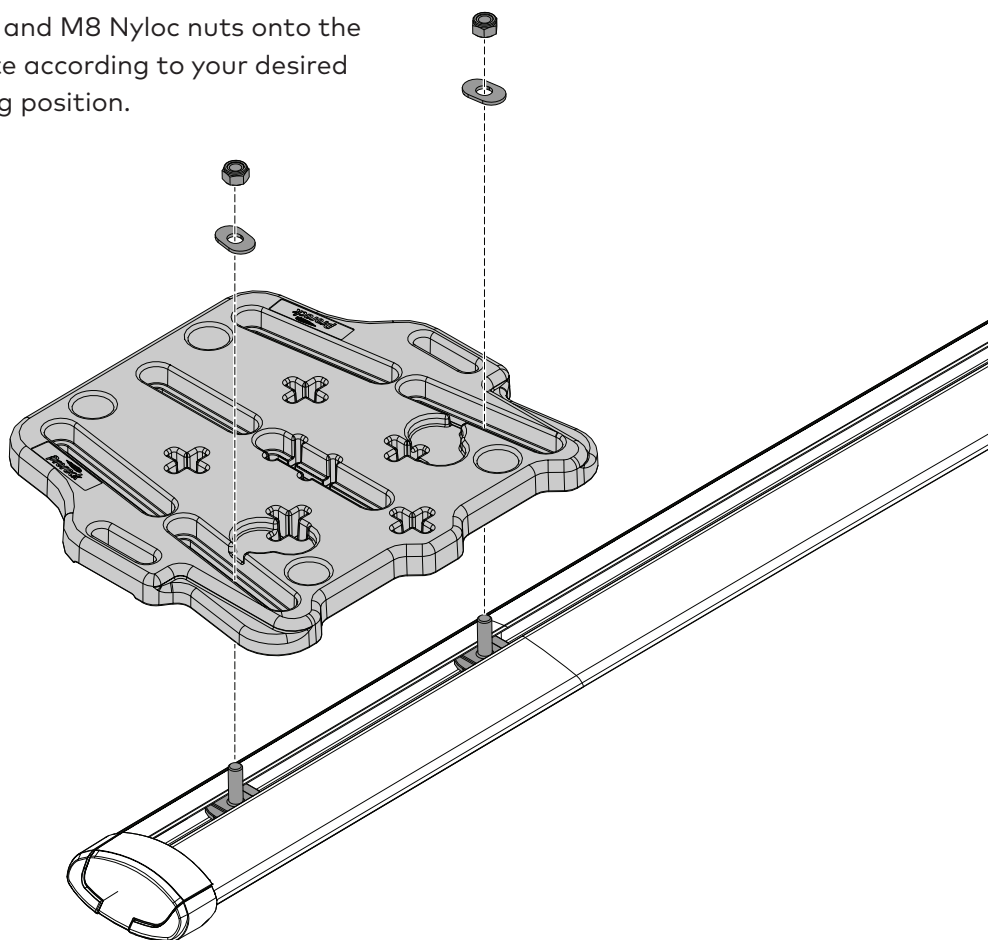
**4****SECURE.**

Tighten the fasteners to 4 Nm using a 13 mm socket and ratchet.

Note: some 1/2" drive large sockets may not fit into the channel to tighten the nut.

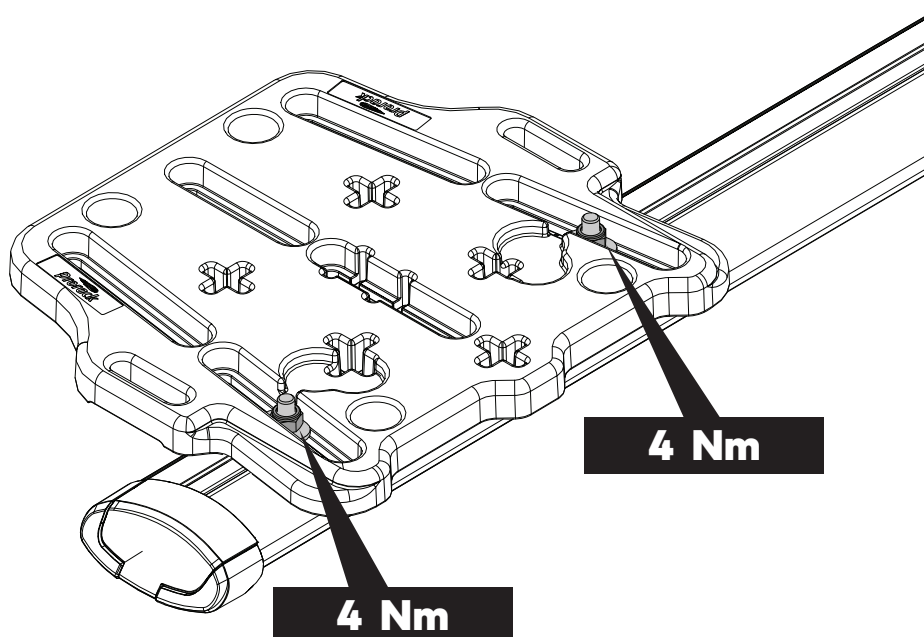

5**INSTALL STRAPS.**

Install and tighten straps per the baseplate installation steps on page 9.

LOCKING CABLE INSTALLATION**SECURING RECOVERY TRACKS USING THE LOCKING CABLE.****1****USING THE LOCKING CABLE.**

The locking cable can be used to keep your recovery tracks safe and secure. Loop around the inside of crossbar leg or platform slat and feed through a keyhole on recovery tracks. Secure with padlock (not supplied).

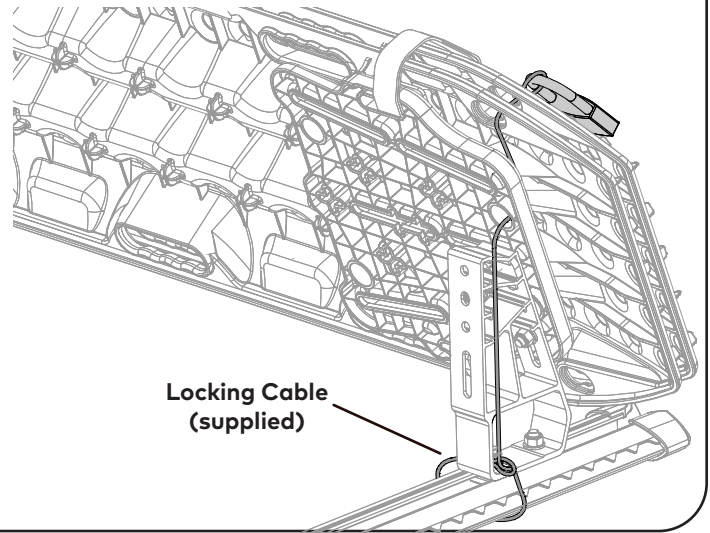

RECOMMENDATIONS

- Check accessory is securely attached whenever you refit it to the vehicle. If the unit feels loose, refer to the fitting instructions and readjust.
- Regularly check all fasteners. This includes all attached accessories and roof racks.
- Remove straps when not in use.
- Clean with hot soapy water and sponge as required.

SAFETY

- The mounting brackets can carry up to 25 kg of equipment per pair. Ensure all items are securely attached.
- Ensure that all loads are distributed evenly across the roof racks and are fastened securely.
- A loaded roof rack system can alter the performance of your vehicle. Be especially aware of the effects of side winds, changing of direction, and braking performance. Avoid rapid acceleration and deceleration. Drive carefully.
- Make sure all loads are securely fastened with non-elastic straps. Check regularly during longer journeys.
- Never drive into a car wash with the roof rack system or accessories fitted.
- Do not exceed the vehicle manufacturer's roof load rating. Total load equals weight of roof racks + accessories + cargo/equipment.

YAKIMA®

www.yakima.com.au
www.yakima.co.nz
www.yakima.com
www.yakima.eu

YAKIMA AUSTRALIA PTY LTD

17 Hinkler Court
Brendale, QLD 4500
Australia
1800 143 548

YAKIMA PRODUCTS, INC.

4101 Kruse Way
Lake Oswego, OR
97035-2541
USA
888 925 4621
yakima.com/support